

B-1039C-X
(6 RIB)

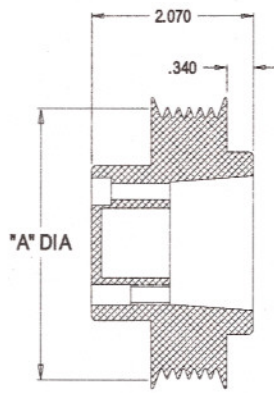

B-1118-X
(6 RIB)

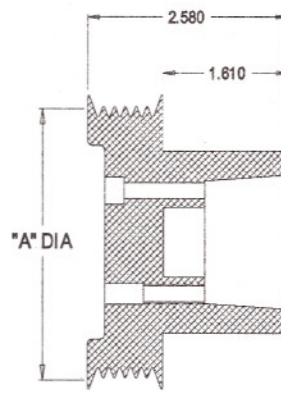

B-1291-X
(6 RIB)

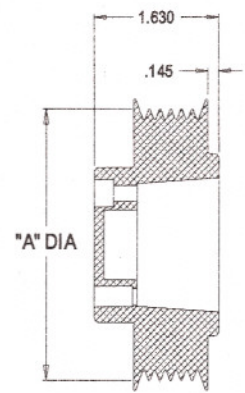

B-1581-X
(6 RIB)

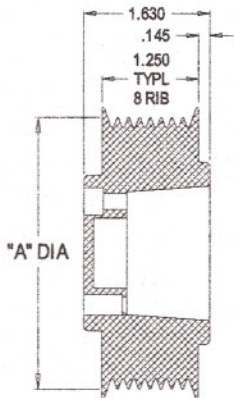

B-1651-X
(8 RIB)

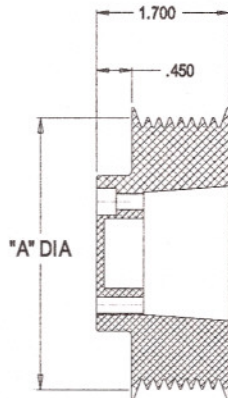

B-1721B-X
(8 RIB)

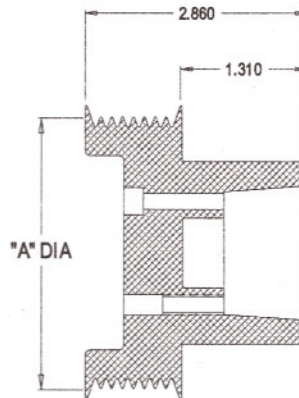

B-1767-X
(8 RIB)

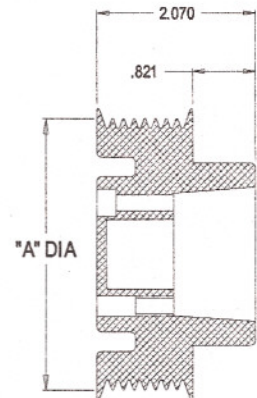

B-1834-X
(8 RIB)

RIB DIAMETER TABLE
-X = "A" DIA = RIB DIA.

-X	"A" DIA
1	2.650
2	2.750
3	2.875
4	3.000
5	3.125
6	3.250
7	3.500
8	3.750
9	3.875
10	4.000
11	4.125
12	4.250

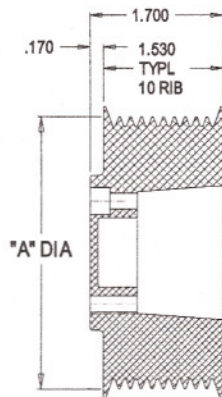

B-1874-X
10 RIB

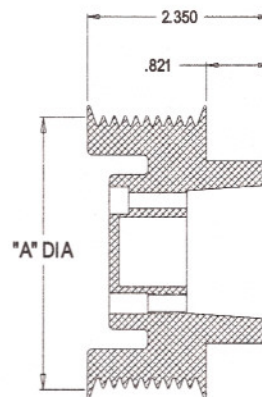

B-1875-X
10 RIB

FLANGE DIA = "A" DIA + 0.225

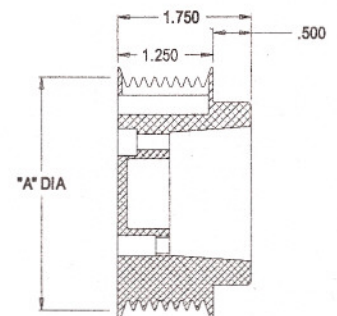

PULLIES HAVE 12 CROSS SLOTS AND VENT HOLES EQUALLY SPACED ON CIRCUMFERENCE FOR IMPROVED BELT GRIP. STANDARD ON ALL DIAS.